

CONSOL-RODEBACK SUBDIVISION

MANCHESTER TOWNSHIP SECTION 33 R 10 TWP 7 MORGAN COUNTY, OHIO

PIN	Owner	LegalDescr	Acres	VOL	PAGE	Survey_Ref
090-003-340-1	GARVEY MATHEW W & JENNY L	R10 T07 S33 CONSOL-ROD	2.099	OR218	710	MAN-0066.pdf
090-003-340-0	GARVEY MATHEW W & JENNY L	R10 T07 S33 CONSOL-ROD	5.257	OR233	2688	Consol-Rodeba
090-003-340-3	KELL STANLEY L III	R10 T07 S33 CONSOL-ROD	5.285	OR227	1920	Consol-Rodeba
090-003-340-2	KELL STANLEY L III	R10 T07 S33 CONSOL-ROD	5.253	OR233	4411	Consol-Rodeba
090-003-341-1	RICHARDS THOMAS W	R10 T07 S33 LOT 2A CONS	3.156	OR211	582	MAN-0066.pdf

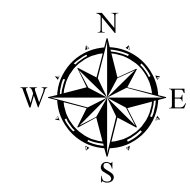
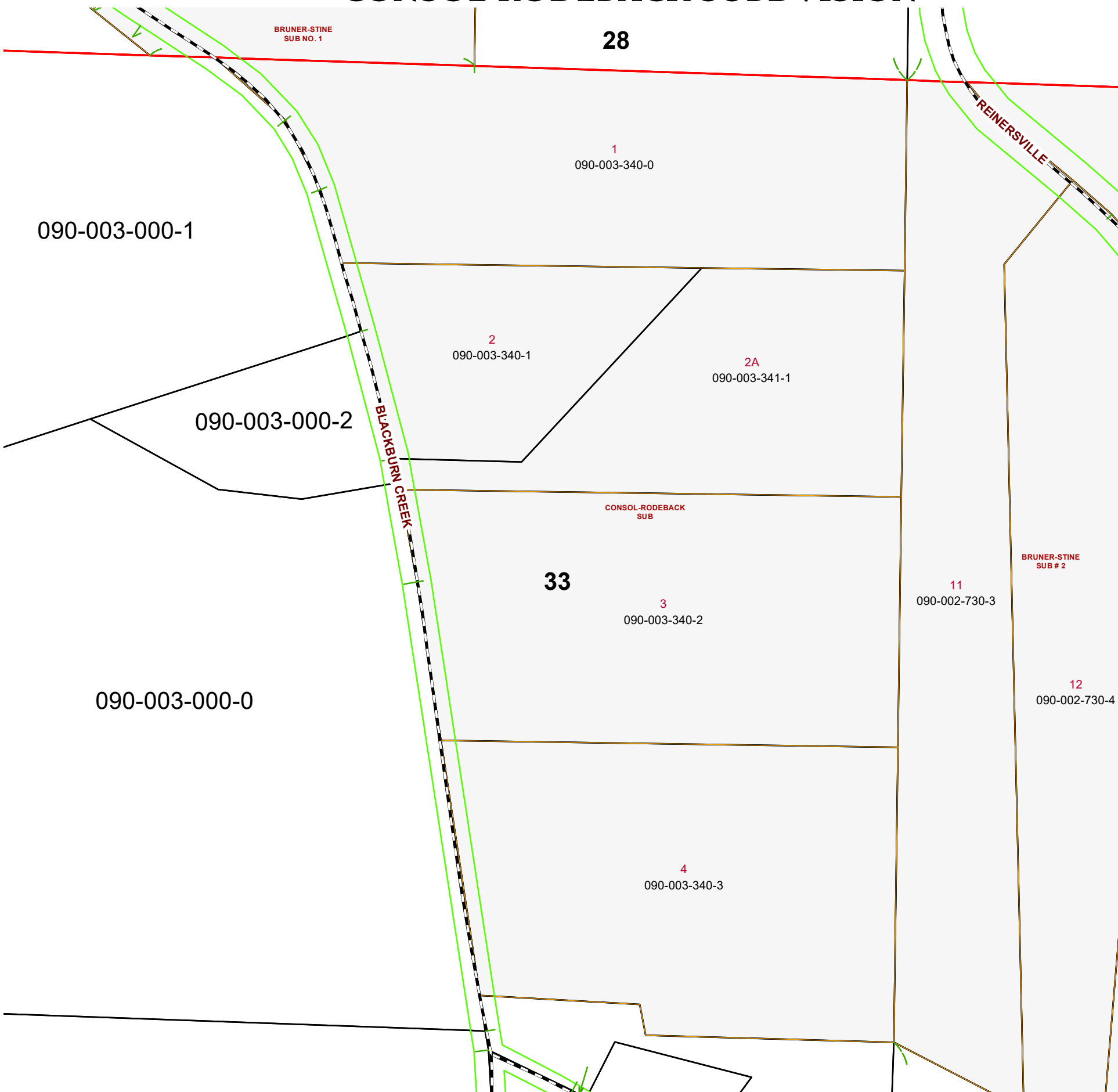

Boundaries			
	Hydro		Section
	Roads		Lot
	County		Township
	Parcel		ROW



Disclaimer: The information that these maps contains is for reference purposes only. Please bring any errors to the attention of the Engineer's Office staff. Thank you

Source: Morgan County Engineer's Office
 Author: Marcia Wolfe
 Date: 12/31/20